



**SEMI-AUTOMATIC
EVEN FLOW BANJO**

Item #4620



INSTRUCTION MANUAL

Advance Equipment Mfg. Co. Inc.
4615 W Chicago Avenue, Chicago, IL 60651 U.S.A.
773.287.8220 • 800.621.4516

made in USA

BANJO TAPER INSTRUCTIONS

- Open tape gate and mount tape to speed wheel with the tape direction moving clockwise. (A)
- Feed tape into mud compartment and out other side by wheel. (B)
- Push the tape clear up to the roof of the machine. (C)
- Pour mud into the body of the banjo taper. (D)
- As the mud becomes used up, the tape will pull down against the curved belly. The belly rolls the mud forward to prevent dry spots on the tape. (E)
- Use thumbscrew at the front of the machine is to adjust the mud-flow. Experiment until you have the appropriate adjustment for your mud. (F)
- Use a standard joint compound (mud), in the Banjo Taper. The compound mix should be similar to the consistency of heavy texture paint, or slightly thinner than usual hand-taping mix. Your joint compound should pour from the mixing container easily.
- Web strap with new ergonomic thumb rest for less hand fatigue. (G)

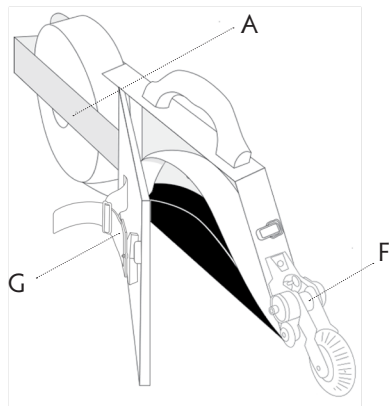

IMPORTANT: KEEP THE BANJO TAPER CLEAN AT ALL TIMES. DO NOT ALLOW MUD TO STAY IN MACHINE FOR MORE THAN A 2 HOUR PERIOD.

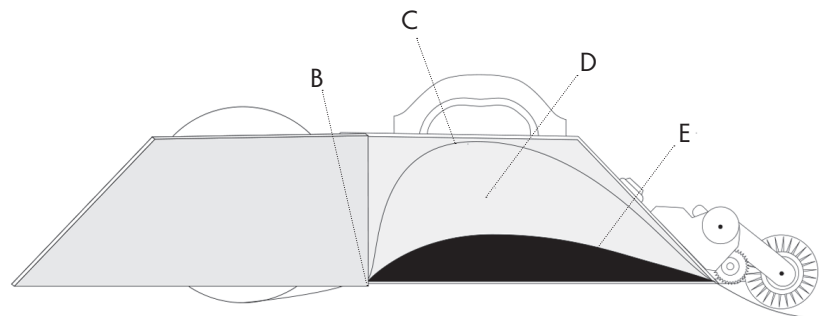

TO ADJUST CORNER WHEEL

- 1 Twist the locking collar Counter-Clockwise to unlock. (1)
- 2 Push the middle pin inward to release locking shaft. (2)
- 3 Adjust the corner wheel to desired position. (Upward for flats and downward for corners)
- 4 Aline the treads and push to re-engage locking shaft. (3)
- 5 Twist the locking collar Clockwise to lock corner wheel. (4)

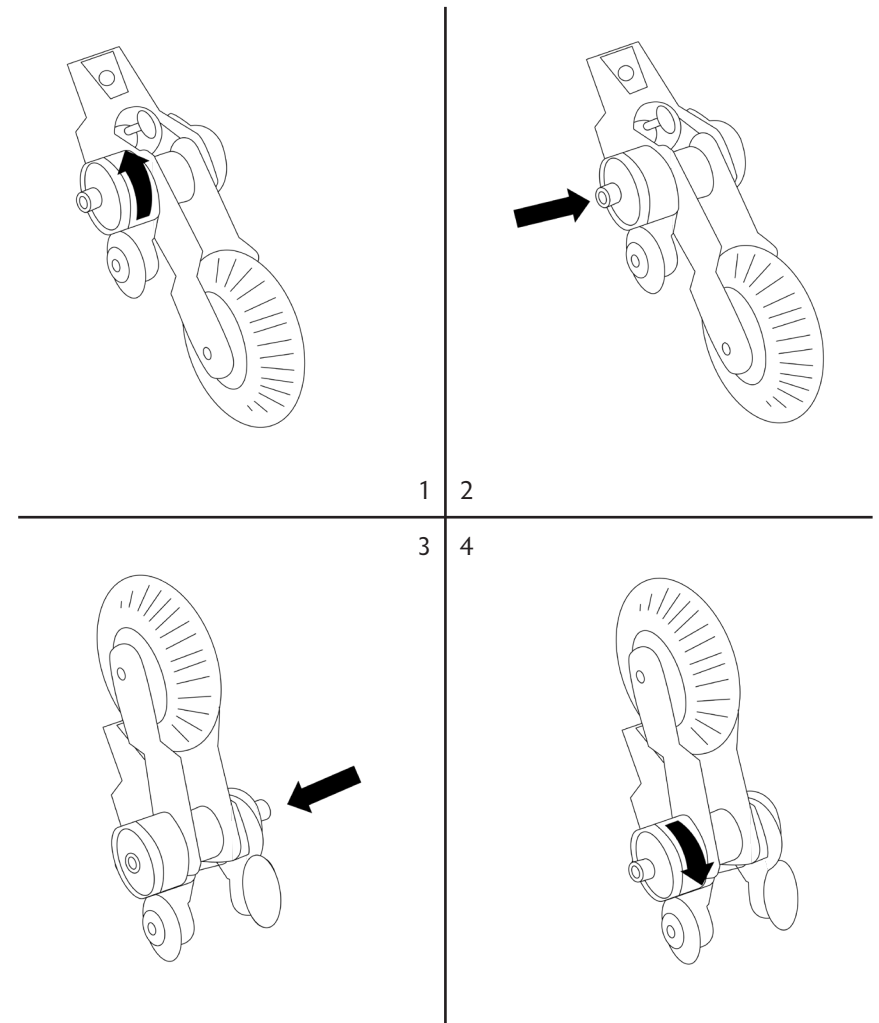

FOR A HOW TO VIDEO PLEASE VISIT US AT: WWW.ADVANCE-EQUIPMENT.COM/EVEN-FLOW-VIDEO

LEFT HANDED STRAP INSTALLATION

- Release latch to open Banjo Taper door and punch out metal from holes on banjo door.
- Install ½" screw from the inside out through hole closest to the banjo door, then the strap, then the nut, and turn to tighten.
- Install ¾" screw from inside out through hole closest to the rear of banjo, on the banjo door. On the outside of the banjo door place the strap, then the nut, and turn to tighten.
- Use the plastic plugs to fill the holes on the banjo body by inserting them through hole from outside to inside.

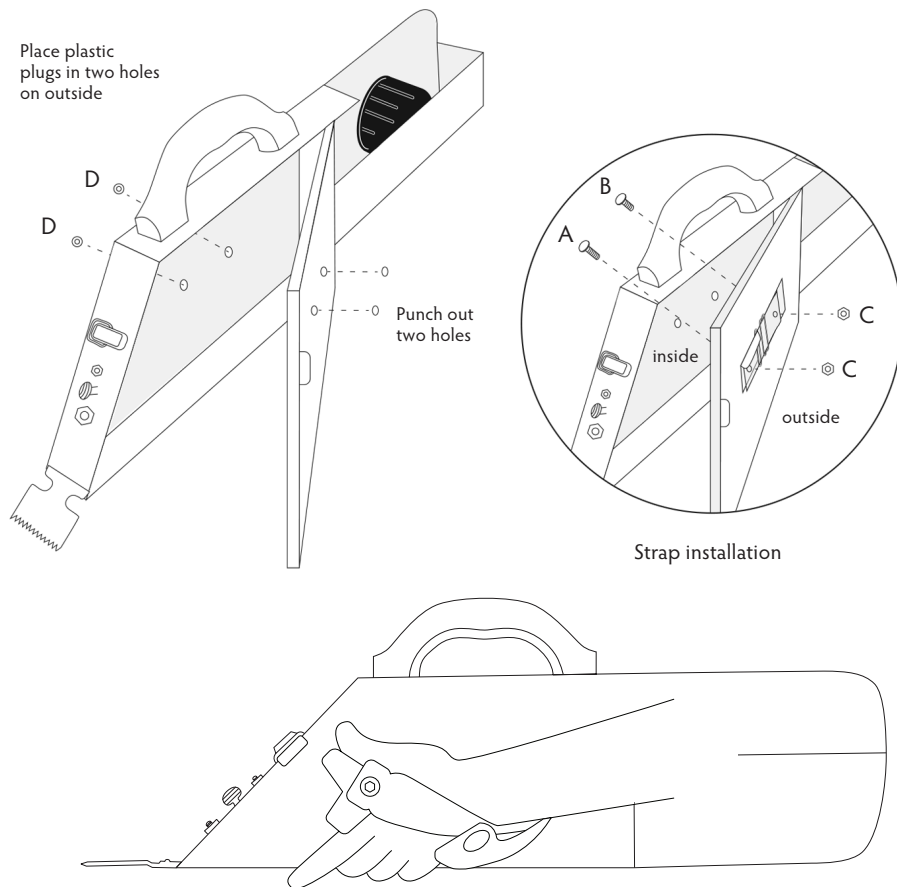

BANJO TAPER



TAPING INSTRUCTIONS & STRAP INSTALLATION

Advance Equipment Mfg. Co. Inc.
4615 W Chicago Avenue, Chicago, IL 60651 U.S.A.
773.287.8220 • 800.621.4516

made in USA



ADVANCE-EQUIPMENT.COM

INCLUDES:



A. 1/2"



B. 3/8"

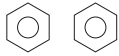

C. 10-24 Nut



D. Plastic Plug

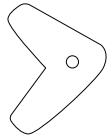

E. Outside Thumb Rest

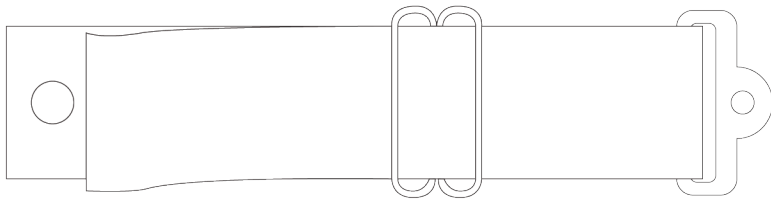

F. Strap

LEFT HANDED STRAP INSTALLATION

- Use a standard joint compound (mud), in the Banjo Taper. The compound mix should be similar to the consistency of heavy texture paint, or slightly thinner than usual hand-taping mix. Your joint compound should pour from the mixing container easily.
- Before putting the mud in the Banjo Taper
 - A. Push the tape clear up to the roof of the machine, near the handle
 - B. Pour your mud into the body of the banjo taper.
 - C. As the mud becomes used up, the tape will pull down against the curved belly. The belly rolls the mud forward to prevent dry spots on the tape.
- The thumbscrew at the front of the machine is used to adjust the mud-flow. Experiment until you have the appropriate adjustment for your mud.

IMPORTANT:

KEEP THE BANJO TAPER CLEAN AT ALL TIMES.
DO NOT ALLOW MUD TO STAY IN MACHINE FOR MORE
THAN A 2 HOUR PERIOD.

RIGHT HANDED STRAP INSTALLATION

- Release latch to open Banjo Taper door. Install 1/2" screw from inside out, through hole closest to the front of banjo, on the banjo body. On the outside of the banjo body, place the thumb rest closest to the banjo body, then the strap, then the nut, and turn to tighten.
- Install 3/8" screw from inside out, through hole closest to the rear of banjo, on the banjo body. On the outside of the banjo body place the strap, then the nut, and turn to tighten.

Tape
Installation

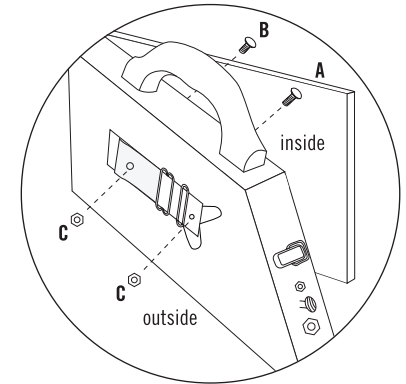
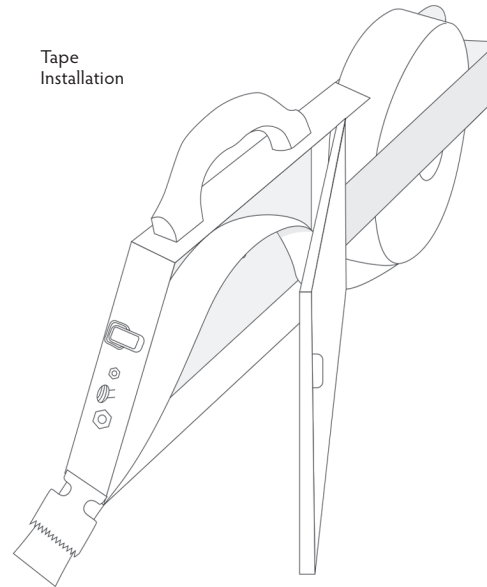

Strap installation

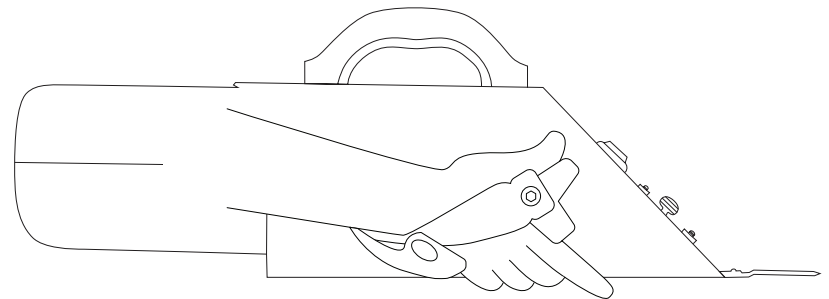



EVEN FLOW CUTTER

Item #4621



INSTRUCTION MANUAL

Advance Equipment Mfg. Co. Inc.
4615 W Chicago Avenue, Chicago, IL 60651 U.S.A.
773.287.8220 • 800.621.4516

made in USA

BANJO TAPER INSTRUCTIONS

- Open tape gate and mount tape to speed wheel with the tape direction moving clockwise. (A)
- Feed tape into mud compartment and out other side by cutter. (B)
- Push the tape clear up to the roof of the machine. (C)
- Pour mud into the body of the banjo taper. (D)
- As the mud becomes used up, the tape will pull down against the curved belly. The belly rolls the mud forward to prevent dry spots on the tape. (E)
- Use thumbscrew at the front of the machine is to adjust the mud-flow. Experiment until you have the appropriate adjustment for your mud. (F)
- Use a standard joint compound (mud), in the Banjo Taper. The compound mix should be similar to the consistency of heavy texture paint, or slightly thinner than usual hand-taping mix. Your joint compound should pour from the mixing container easily.
- Web strap with new ergonomic thumb rest for less hand fatigue. (G)

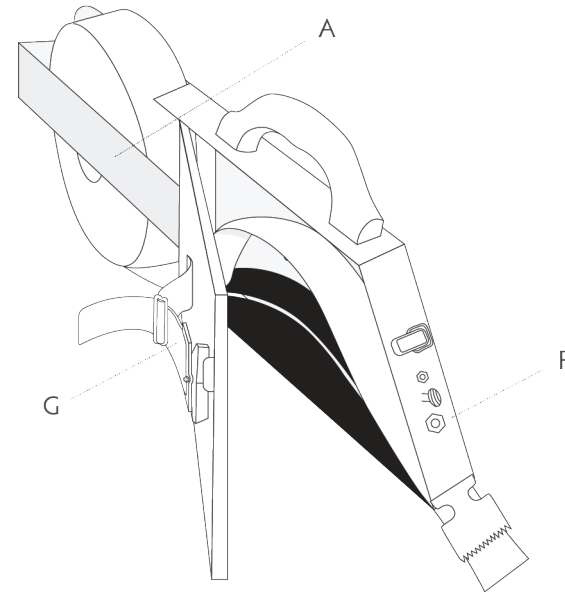

IMPORTANT:

KEEP THE BANJO TAPER CLEAN AT ALL TIMES.
DO NOT ALLOW MUD TO STAY IN MACHINE FOR MORE
THAN A 2 HOUR PERIOD.

