

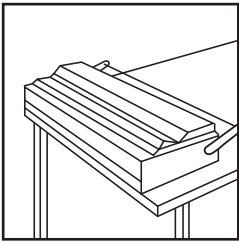

## 30" QWIKPASTER

Please specify machine width when ordering parts:



**1.**

Place Qwikpaster into position, install the wallpaper roll mount.

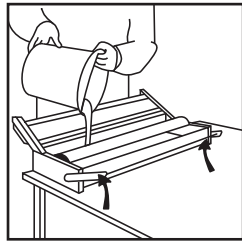

**2.**

Fill paste into paste trough up to line on side of trough. Adjust paste skimmer with the two regulating screws (2 to 3 times wall paper thickness).

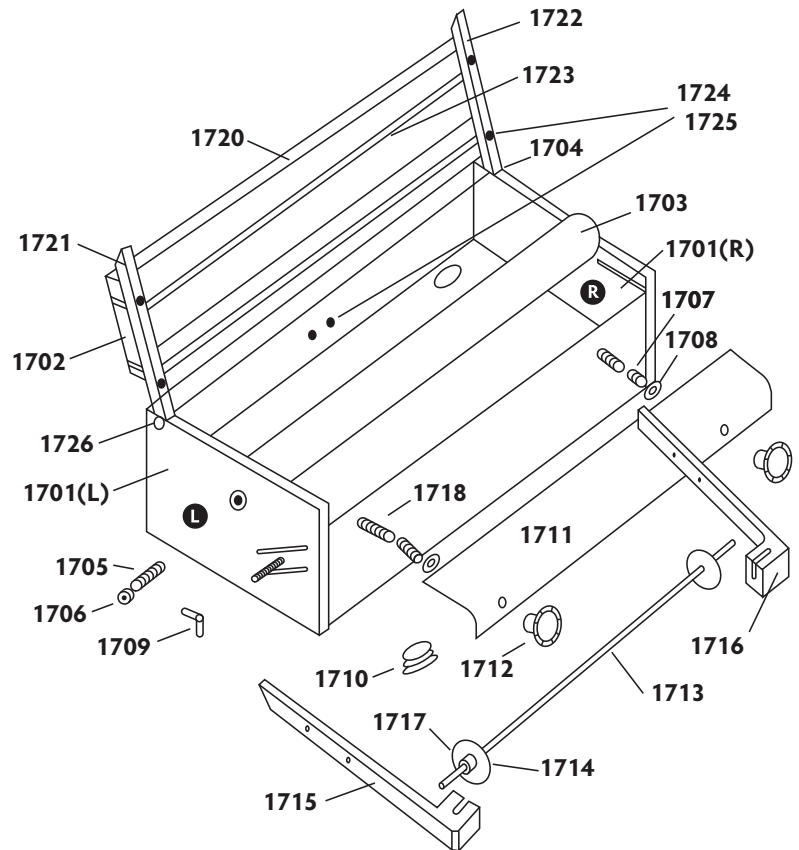

## COUNTER PARTS LIST

1740	Counter
1741	Counter Hinge
1742	Gear
1743	Allen Wrench

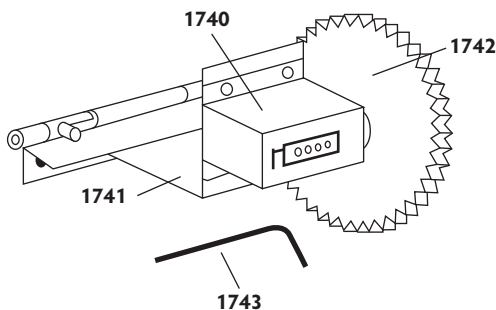

## PARTS LIST

1701 (L or R)	Side Cover
1702	Lid Assembly
1703	Pasting Roller
1704	Material Pick-Up Rod
1705	Roller Support Pin (2)
1706	Nut (2)
1707	Spring (2)
1708	Washer (2)
1709	Wingnut (2)
1710	Drain Plug
1711	Scraper Blade
1712	Paste Control Knob (2)
1713	Material Support Bar

1714	Material Disc (2)
1715	Support Arm, Left
1716	Support Arm, Right
1717	Locking Screw (2)
1718	Screw OP Paste Control
1720	Stainless Steel Lid
1721	Lid Bracket, Left
1722	Lid Bracket, Right
1723	Lid Roller (2)
1724	Lid and Counter Screws
1725	Lid and Counter Nuts
1726	Rod Cap (2)

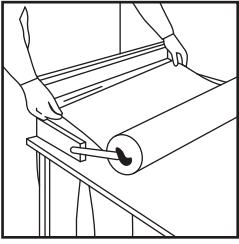

**3.**

Place wallpaper roll on the roll mount and pull wallpaper across the paste roller (wallpaper design must face upward).

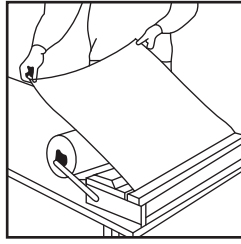

**4.**

Close lid and pull wallpaper out. Measure from cutting edge on lid.

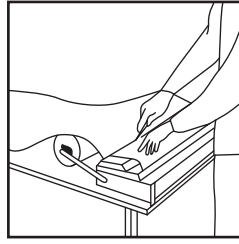

**5.**

Cut wallpaper on edge with razor blade or knife.

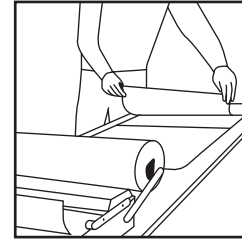

**6.**

Fold wallpaper and let it soak.

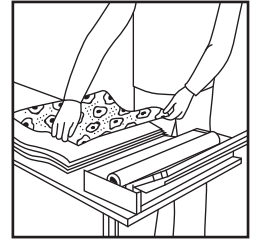

**\***

Wallpaper with design intervals: Use Qwikpaster as a cutting device before filling in paste. Then pull the cut wallpaper through one at a time.

## **ADHESIVE INSTRUCTIONS**

- 1.** The Qwikpaster is designed for light duty residential materials.
- 2.** As the machine is not gear driven and only has a shallow, rectangular tray without a pick-up roller, lighter adhesive has to be used.
- 3.** The machine works very well with prespasted activator which is formulated for prepasted materials. This can be used straight from the container.
- 4.** For unpasted materials use a clear adhesive which in most cases has to be diluted with water and vigorously mixed, preferably with an electric mixer.
- 5.** When the paste is in the tray it will have to flow easily. Tilt the paste machine and observe if the paste will flow from the front of the tank to the rear and vice-versa.
- 6.** The machine will not operate properly with clay adhesive nor with water only.

**ADVANCE EQUIPMENT MANUFACTURING CO., INC.**

4615 West Chicago Avenue | Chicago, Illinois 60651

Telephone 773-287-8220 | Fax 773-287-9889 | 800-621-4516

[www.advance-equipment.com](http://www.advance-equipment.com)